

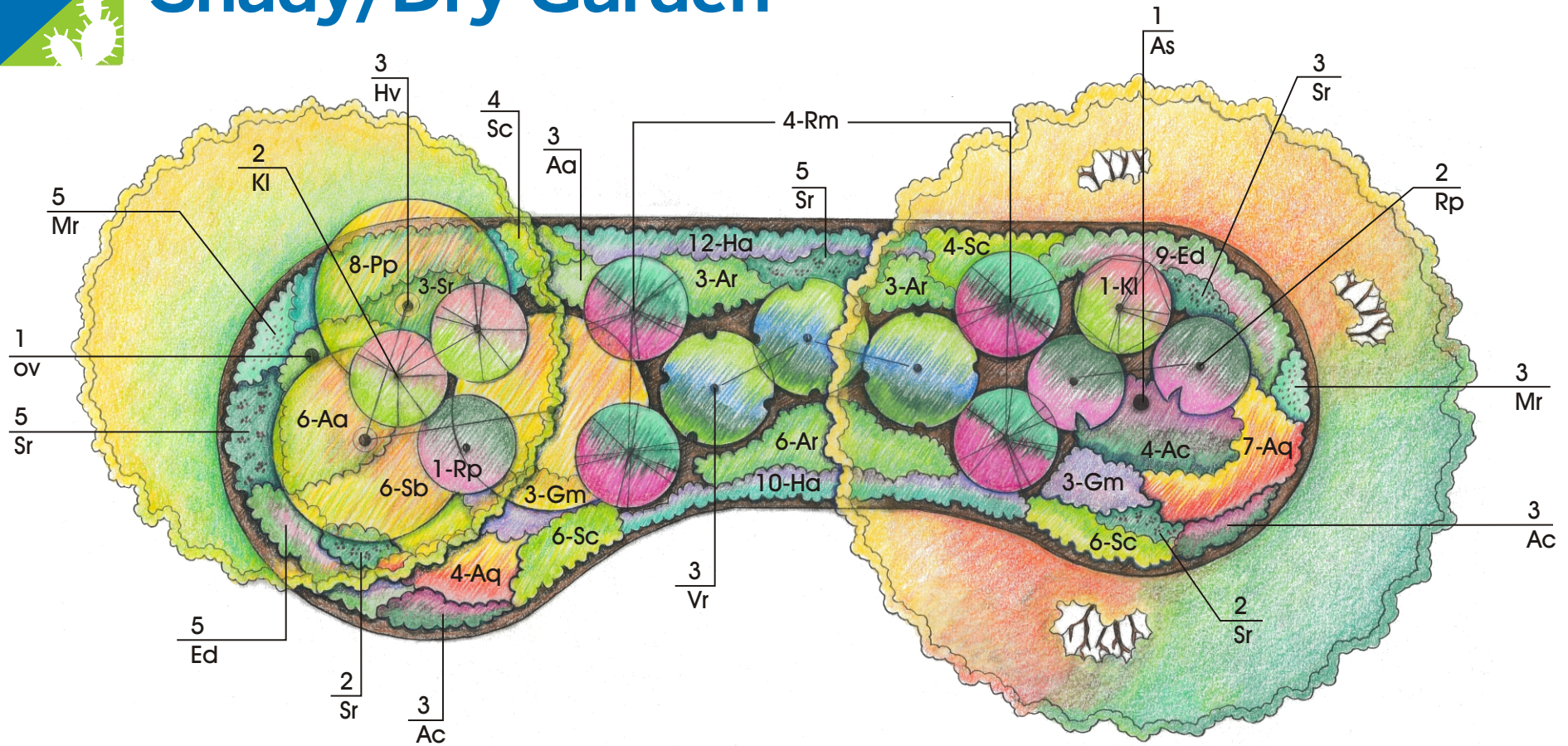

Shady/Dry Garden



Shrubs:

- 3 - Hv *Hamamelis virginiana* - Witch-hazel
- 3 - Kl *Kalmia latifolia* - Mountain laurel
- 4 - Rm *Rhododendron maximum* - Rosebay
- 3 - Rp *Rhododendron periclymenoides* - Pinxter flower
- 3 - Vr *Viburnum recognitum* - Arrow-wood

Perennials:

- 11 - Aq *Aquilegia canadensis* - Wild columbine
- 6 - Ac *Asarum canadense* - Wild ginger
- 14 - Ed *Eurybia (Aster) divaricatus* - White wood aster
- 12 - Ar *Actea racemosa (Cimicifuga)* - Black cohosh
- 9 - Aa *Ageratina altissima (Eupatorium rugosum)* - White snakeroot
- 6 - Gm *Geranium maculatum* - Wild geranium
- 22 - Ha *Heuchera americana* - Alumroot
- 8 - Mr *Mitchella repens* - Partridge-berry
- 8 - Pp *Podophyllum peltatum* - Mayapple
- 12 - Sc *Sanguinaria canadensis* - Bloodroot
- 20 - Sr *Smilacina racemosa* - False Solomon's seal
- 6 - Sb *Solidago bicolor* - White goldenrod

Trees

- 1 - As *Acer saccharum* - Sugar maple
- 1 - Ov *Ostrya virginiana* - Hop hornbeam

Scale 3/16" = 1'-0