

NEWS RELEASE

From the Brodhead Watershed Association

FOR IMMEDIATE RELEASE

Wednesday, October 08, 2014

(Please do not print after October 18, 2014)

Brodhead Watershed Association Hosts:

**Where in the Watershed Walk #8 - Cherry Creek Headwaters -
Cherry Valley Ridge Trails on Saturday, October 18th from
1-4:30pm**

Join BWA/PHLT members/friends for this next in the series of monthly "Where in the Watershed" Walks led by BWA/PHLT Board member and naturalist Don Miller and PHLT Board member, naturalist and wild plant/old growth forest enthusiast, Bill Sweeney. This month's exploration will be on the Cherry Valley Ridge Trail system in the Cherry Valley National Wildlife Refuge's newly acquired Sorrenti Tract. Bring your binoculars and enjoy prime fall foliage.

This moderate difficulty hike will be on and off trail on level and sloped terrain along the ridge overlooking the headwaters of Cherry Creek and Aquashicola Creek. Discover the Brodhead Creek/Delaware River and Lehigh River watershed divide, and learn some of the history of our National Wildlife Refuge System. Enjoy being in the midst of the annual fall bird migration with views of migrating songbirds, raptors and the Appalachian Ridge in "full fall bloom". To learn more about Cherry Valley NWR visit

http://www.fws.gov/refuge/cherry_valley/ and Friends of CVNWR visit <http://www.friendsofcherryvalley.com/>

Participants should meet at 1:00 in the CVNWR trailhead parking area adjacent to the Cherry Valley Vineyard on Lower Cherry Valley Road just off Rt. 115 South accessed via the Saylorburg Exit off Rt. 33 South. For additional WitW Walk information and/or directions call PHLT. 570-424-1514 or BWA 570-839-1120. Pre- registration is requested. To register, please call the Pocono Heritage Land Trust (PHLT) office Monday to Friday at 570-424-1514. * Hike donation is \$5.00 per person (\$3.00 per BWA/PHLT member) to be collected at the start of the hike. * Optional Wood Fired Brick Oven Pizza and Cherry Valley Wine is available after the hike at Pizzeria Mamma Lucia at Cherry Valley Vineyard. More information & menu at <http://www.cherryvalleyvineyards.com/images/pizzeria%20menu.pdf>

Cherry Valley Ridge Trail

0 185 370 740 1,110 1,480
Feet

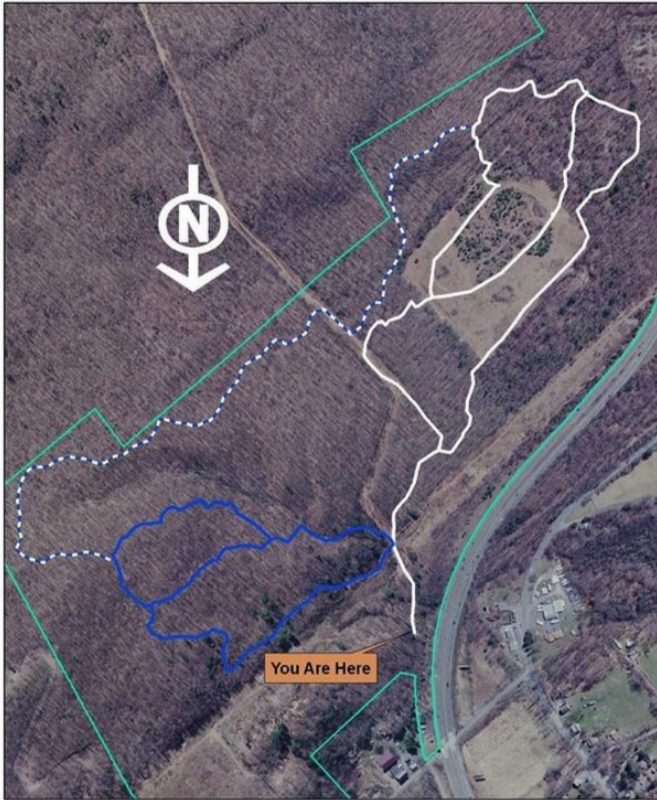

Cherry Valley National Wildlife Refuge was established in December 2008 for the conservation of migratory birds and federal trust species, and the habitats they depend on. The lands and waters of the Cherry Valley have been widely recognized for their valuable natural resources. These include a diverse mosaic of wetland and upland habitats that support an unusually large number of federal trust species, including five federally listed threatened or endangered species. The Kittatinny Ridge (which flanks the south side of the valley) has been designated an Important Bird Area by the Pennsylvania Audubon Society, and is a well-known migration flyway that concentrates up to 20,000 migrating raptors and more than 140 bird species every fall. Large blocks of unfragmented forest along the ridge also serve as valuable breeding areas for interior-forest birds. Nearly 2000 contiguous Cherry Valley acres have already been protected by donation, purchase or easement.

The BWA, 25 years of protecting our environment and watershed resources

The Brodhead Watershed Association is a non-profit environmental organization formed in 1989. BWA is dedicated to protecting and preserving water resources and the environment of the Brodhead watershed and the water quality of the Brodhead, Cherry, Marshalls, McMichael, Paradise and Pocono creeks and their tributaries. The BWA assists municipalities, residents, businesses and groups with protecting natural resources through education, workshops, seminars, public programs and stream monitoring.

For More Information Contact: The Brodhead Watershed Office
Email: info@brodheadwatershed.org Phone: 570 839 1120